

John Beahm

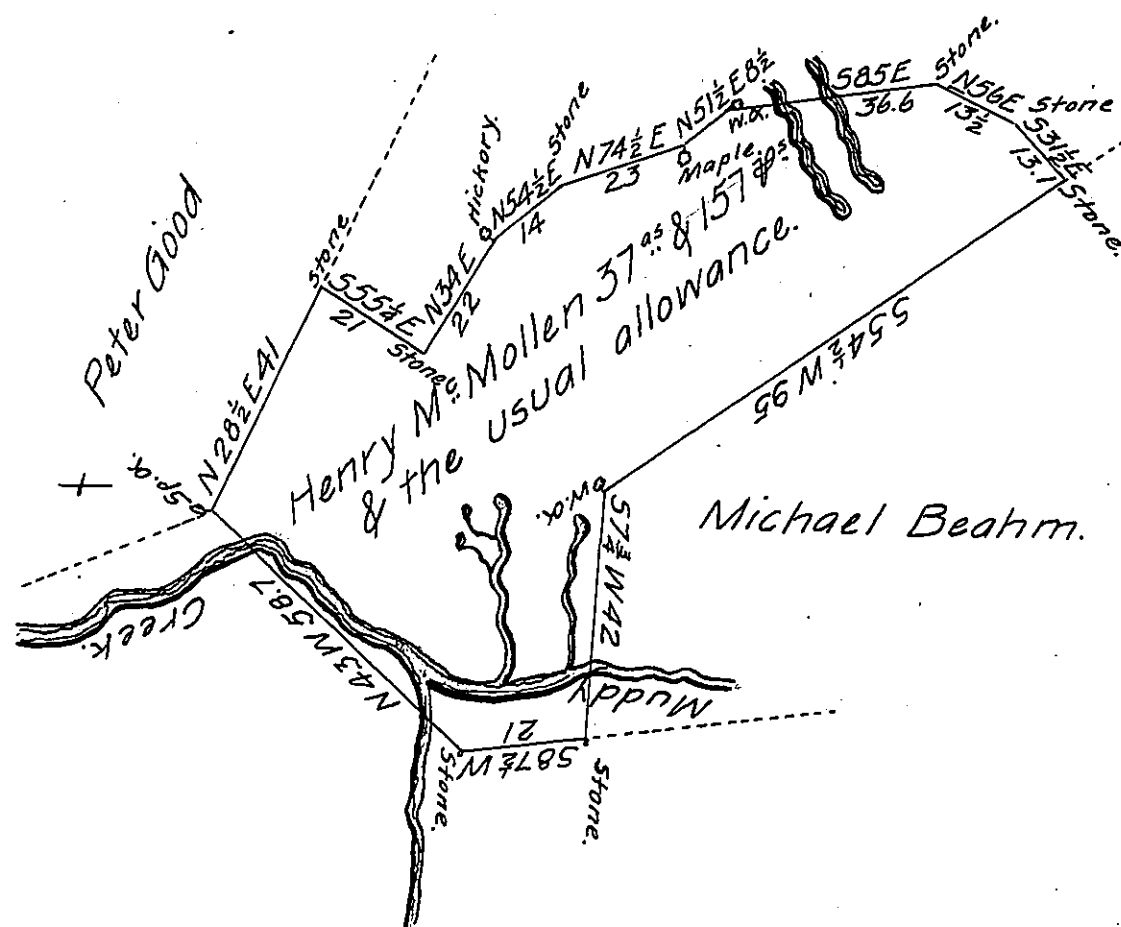

Robert Jirkins Esq.

A Draught of a piece or Tract of Land Situate in Brecknock Town-
 ship Lancaster County Containing 37^{as} & 157^{ps} and the usual allowance
 of Six $\frac{1}{2}$ Cent for Roads &c.^o Surveyed the 5th day of September A.D.
 1809 for Christian Schneder Ju^r in Right of Henry M^cMollen (It be-
 ing part of a Larger Tract of 152^{as} & the allowance Formerly Survey-
 ed unto the said Henry M^cMollen By Virtue of a Warrant Dated
 the 7th Day of December A.D. 1750

Jacob Hibshman D.S.

To Andrew Porter Esq.
 Surveyor General

IN TESTIMONY that the above is a copy of the original remaining on file in
 the Department of Internal Affairs of Pennsylvania, made
 conformably to an Act of Assembly approved the 16th day of
 February, 1833, I have hereunto set my Hand and caused
 the Seal of said Department to be affixed at Harrisburg,
 -this eighth day of January 1906.

Joseph R. Reason
 Secretary of Internal Affairs.